

# PHILIPS hue

### Warnings

Always make sure the luminaire is detached from the mains socket  
Always make sure the DC cable is detached from the power supply  
Staring at the operating light source may cause eye injury

#	Disassemble/dismantle steps	Tools needed
a	Press and rotate diffuser [12] by hand counter clockwise until it unsnap. Lift the diffuser up to remove it from base [13]	-
b	Remove deco ring [11] by lifting up from the base [13]	-
c	Unplug wires from light source-led modules [5]	WAGO TOOL #2060
d	Unplug wires from light source - splitter [4]	WAGO TOOL #2060
e	Remove low voltage wires of Control gear - psu [2] from Light source - hue connect [3]	FLATHEAD SCREWDRIVER OR WAGO TOOL #2065
f	Remove flat cable from the light source - splitter [4] and light source - hue connect [3]	-
g	Unscrew 1 screw [1] and remove light source-hue connect [3]	TORXHEAD SCREW DRIVER T10
h	Unscrew 20 screws [1] and remove light source -led modules [5] and plates [16]	TORXHEAD SCREW DRIVER T10
i	Unscrew 2 screws [1] and remove light source - splitter [4]	TORXHEAD SCREW DRIVER T10
j	Rotate bracket [14] by hand counter clockwise until it unsnap. Lift bracket up to remove it from base [13]	-
k	Remove terminal blocks [10] by unscrewing wires of the control gear - psu [2], remove cover N [8] and cover L [17]	FLATHEAD SCREWDRIVER
l	Unscrew 3 screws [7] and remove suspension cables [15] and washers [9] from base [13]	TORXHEAD SCREW DRIVER T10
m	Unscrew 1 screw [6] and remove it from bracket [14]	CROSSHEAD SCREWDRIVER PZ
n	Unscrew 2 screws [7] and remove control gear [2] from base [13]	TORXHEAD SCREW DRIVER T10
o	Loosen 4 screws in control gear - psu [2] and remove wires	CROSSHEAD SCREWDRIVER PH

#	COMPONENT	QTY
1	Screw	23
2	Control gear - psu	1
3	Light source - hue connect	1
4	Light source - splitter	1
5	Light source -led module	10
6	Screw	1
7	Screw	5
8	Cover N	1
9	Washer	3
10	Terminal block	2
11	Deco ring	1
12	Diffuser	1
13	Base	1
14	Bracket	1
15	Suspension cable	3
16	Plate	10
17	Cover L	1

SKU	Color	Country
915005997001	White	EU/UK
915005997101	Black	EU/UK

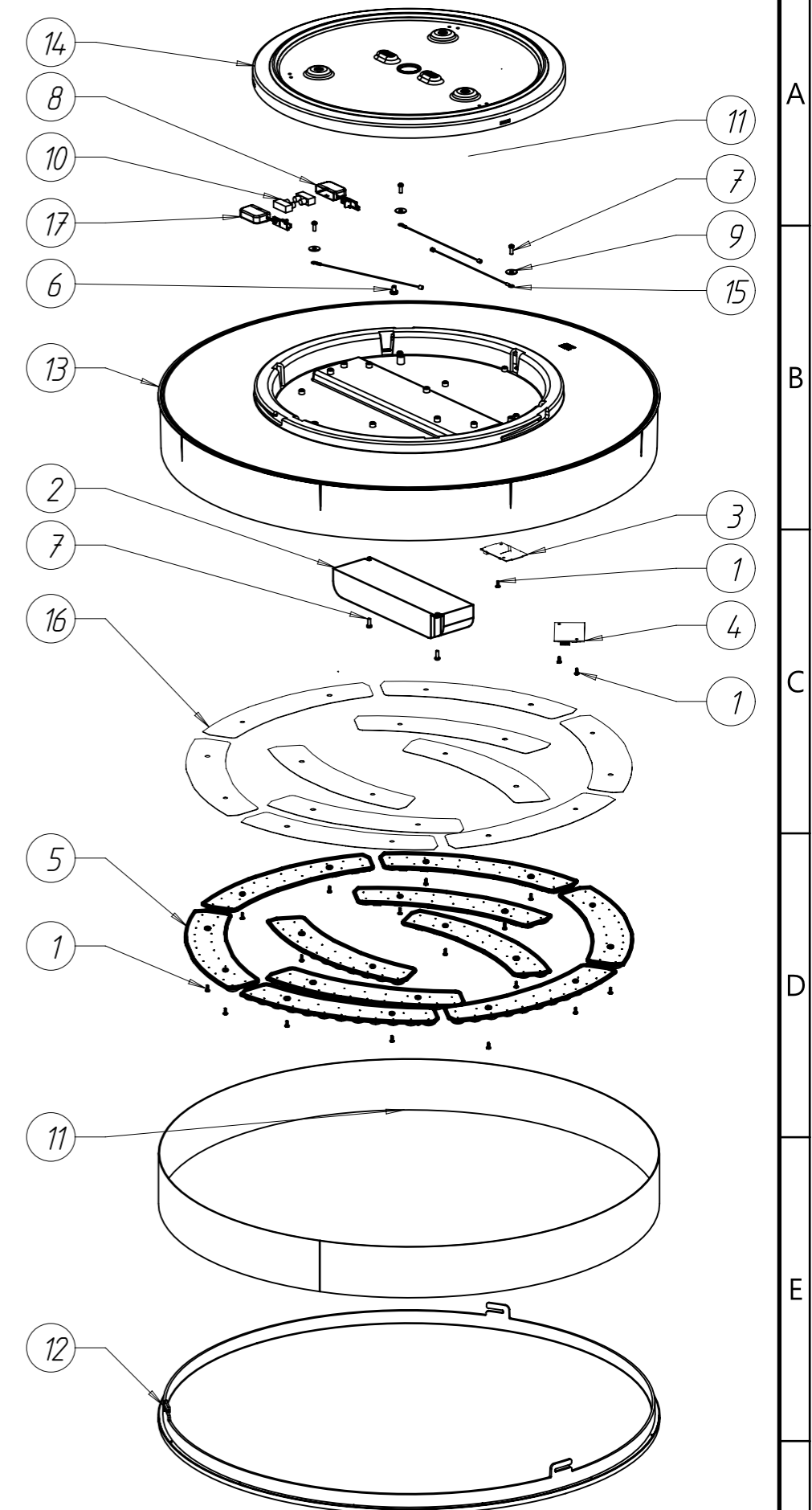

STATUS	DESCRIPTION D0068530 Enrave XL ceiling lamp white/black/white IP44 1x49W 24V, Disassembly instruction	DESIGN ID D0068530	01	2021-06-10
NAME	Kudlaty, Pawel	LOCAL PART ID	SH. 1	SH.
CHECKED	DATE 2021-06-10			A3-L
CONFIDENTIAL, PROPERTY OF: © 2020 Signify Holding				